



METWOODSTORE.COM Now Open for Joist Reinforcer Sales

Metwood Joist Reinforcers restore the strength of Floor Joists compromised by large holes or cut-outs. Metwood Joist Reinforcers are engineered light gauge steel add-ons, that give greater flexibility in the routing and installation of utilities when using Engineered I-Joists, 2 x 8's, 2 x 10's, or 2 x 12's. This allows utilities to be recessed and concealed in the floor system, keeping a finished flush line to attach ceiling materials for finished floors or space below the floor.

Routing utilities through the floor system simplifies construction by eliminating the need for bulkheads and chases, and special engineering on floor framing systems which lower ceiling heights. Metwood Joist Reinforcers are install quickly by simply gluing, and/

or screwing the components to the side of the Floor Joist (Screws included).



Now you can purchase Metwood Joist Reinforcers online! The new store simplifies placing Joist Reinforcer orders and speeds up the delivery process. Simply choose your application, complete the online form, and submit. Your application is reviewed automatically for proper requirements - if your application meets required specifications you are forwarded to the shopping cart where you can complete your purchase. In no time at all your Reinforcers will be on their way to you.

I-Joist Flange Reinforcer	Part#	Joist Depth	Notch size equal to or less than	Minumim Distance from Bearing Wall to Notch Center	MSRP	
	56FR9	9.5"	3.25"h x 5"w	18" or more	\$89.95	
	56FR11	11.875"	4"h x 5"w	18" or more	\$89.95	
	75FR9	9.5"	3.25"h x 5"w	18" or more	\$89.95	
	75FR11	11.875"	4"h x 5"w	18" or more	\$89.95	
	75FR14	14"	4"h x 5"w	18" or more	\$99.95	
	75FR16	16"	4"h x 5"w	18" or more	\$99.95	
	100FR9	9.5"	3.25"h x 5"w	18" or more	\$89.95	
	100FR11	11.875"	4"h x 5"w	18" or more	\$89.95	
	100FR14	14"	4"h x 5"w	18" or more	\$99.95	
	100FR16	16"	4"h x 5"w	18" or more	\$99.95	
	150FR11	11.875"	4"h x 5"w	18" or more	\$89.95	
	150FR14	14"	4"h x 5"w	18" or more	\$99.95	
	150FR16	16"	4"h x 5"w	18" or more	\$99.95	
I-Joist Web Reinforcer	Part #	Joist Depth	Hole size equal to or less than	Minumim Distance from Bearing Wall to Notch Center	MSRP	
	56WR911	9.5" or 11.875"	5.5"h x 12"w	18" or more	\$59.95	
	75WR911	9.5" or 11.875"	5.5"h x 12"w	18" or more	\$59.95	
	75WR1416	14" or 16"	10"-12"h x 16"w	18" or more	\$69.95	
	100WR911	9.5" or 11.875"	5.5"h x 12"w	18" or more	\$59.95	
	100WR1416	14" or 16"	10" to 12"h x 16"w	18" or more	\$69.95	
	150WR911	9.5" or 11.875"	5.5"h x 12"w	18" or more	\$59.95	
	150WR1416	14" to 16"	10" to 12"h x 16"w	18" or more	\$69.95	
2" x 8" -12 Hole Reinforcer	Part #	Joist Depth	Hole size equal to or less than	Minumim Distance from Bearing Wall to Notch Center	MSRP	
 Legacy Report 97-73	210HR	2" x 10" or 12"	6" dia.	18" or more	\$16.95	
	2810HR	2" x 8", 10", or 12"	6" dia.	18" or more	\$18.95	
2" x 10" Notch Reinforcer	Part #	Joist Depth	Hole size equal to or less than	Minumim Distance from Bearing Wall to Notch Center	MSRP	
	210NR	2" x 10"	3.5"h x 5"w	18" or more	\$16.95	

I-Joist Notch Reinforcer

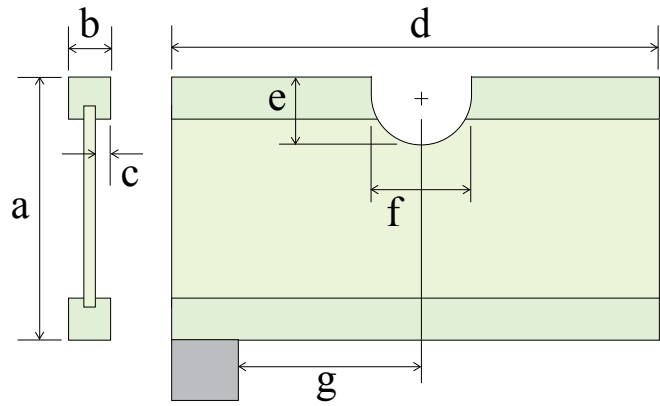

I-Joist Web Reinforcer

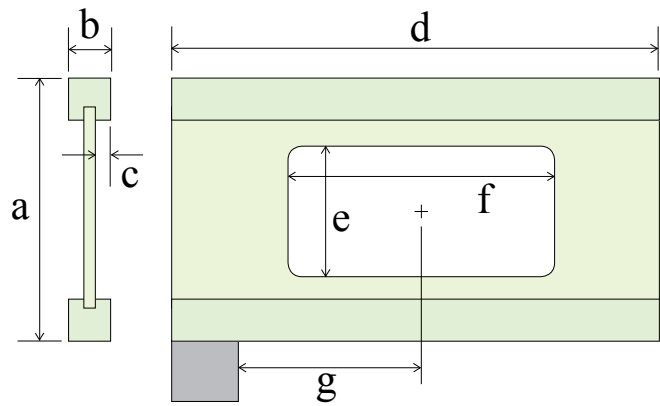

Notch Reinforcer

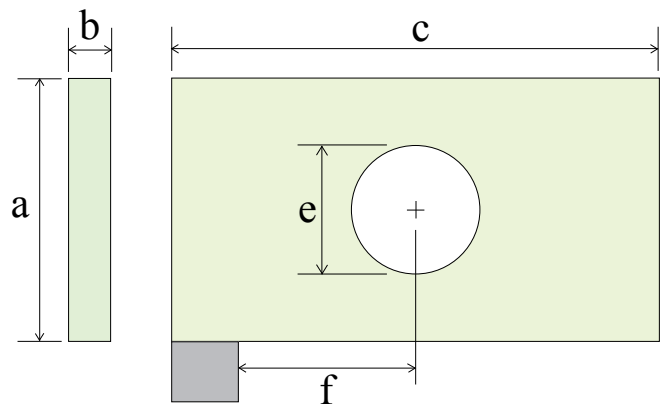

Hole Reinforcer

